

# Overlander



Product Code: DMFVOL

- Built on an F-Series Diesel truck.
- Recommended for 4 adults and 2 children.

## Special Feature

- Awning.
- Slide-out.
- Generator.
- Family friendly with 4 separate seats in driver cab.
- Ford F550 with Diesel engine, up to 30% more fuel efficient than comparable C-Class.
- 4x4.

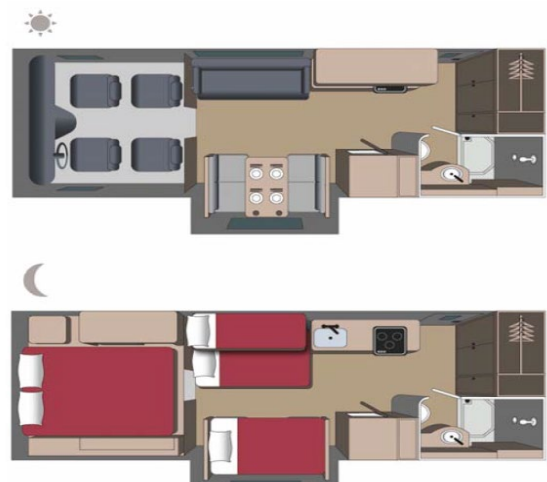

FLOOR PLANS, VEHICLE FEATURES AND SPECIFICATIONS ARE SUBJECT TO CHANGES WITHOUT NOTICE.

## Passenger Capacity

- Sleeping Capacity - 6.
- Recommended for – Up to 4 adults and 2 children.
- Seat Belts – 8.
- Rear 3-point seat belt – No.
- Child Seat option – Yes.

## Vehicle Dimensions

- Exterior Length - 888 cm / 29'2"
- Exterior Width - 250 cm / 98.2'
- Exterior Width with slide-out extended – 290 cm / 114.5"
- Exterior Height – 342 cm / 134.5"
- Interior Height – 199 cm / 78.5"

## Vehicle Specifications

- Chassis make – Ford F550
- Fuel type - Diesel
- Fuel consumption – 18 to 25 litre per 100 km
- Engine size – V10
- Auto transmission – Yes
- 4x4 – No
- Cruise control – Yes
- Navigation system – No
- Dashboard A/C – Yes
- Dual battery – Yes
- Battery boost switch – Yes
- Backup camera – Yes

## Media Compatibility\*

- CD-player - No
- Auxiliary plugin - No
- USB-stick - Yes
- iPhone via USB - Yes
- Android via USB - No
- Bluetooth – Yes

## RV Features

- Fridge and freezer – Yes
- Stove – Yes
- Oven – Propane
- Microwave – Yes
- Furnace – Yes
- Roof A/C – Yes
- Hot water heater – Yes
- Flush toilet – Yes
- Shower – Yes
- Generator – Yes
- Solar panel – Yes
- Awning – Yes

## Sleeping Specifications

- Over-cab bed - 152 x 203 cm / 60" x 80"
- Dinette bed - 111 x 182 cm / 42" x 72"
- Lower Bunk Bed – 129 x 183 cm / 51" x 72"
- Upper Bunk bed – 66 x 180 cm / 26" x 71"
- Safety net in over-cab bed – No

## Tank Capacities

- Fuel tank – 150 litres
- Fresh water – 144 litres
- Black water – 102 litres
- Grey water – 106 litres
- Propane - 85 litres

## Seat Belt Configuration

- \*Forward facing dinette seating - 2 three-point seatbelts with tether hooks for up to 2 infant, child, or booster seats.
- \*Rear facing dinette seating - 2 lap belts with tether hooks for up to 2 child seats.
- Sideways facing bench seating - 3 lap belts, but no infant, child, or booster seat installation possible.

## Notes:

- \*We do not guarantee compatibility with any media device.
- \*Dinette table may need to be lowered when infant seats are installed, meaning that no adults can sit in the dinette when travelling.
- All specifications and measurements are approximate and subject to change.